

AEROSPACE TECHNOLOGY PARK

2000 AEROSPACE
PKWY
BROOK PARK, OHIO



PROPERTY HIGHLIGHTS



TOTAL BUILDING

24,000 SF



SQ FT AVAILABLE

2,500 SF - 15,923 SF



YEAR BUILT

1990



BASE RENT

\$17.50 / SF



NUMBER OF ELEVATORS

One



HVAC SYSTEM

4 Units VAV



PARKING SPACES

204 Spaces (8.5 / 1,000 SF)



COMMUNICATION

Fully Wired / AT&T Fiber



COMMON AREA FACTOR

10%



ADDITIONAL COSTS

In-suite electric and cleaning

AEROSPACE TECHNOLOGY PARK



CHILMARK PROPERTIES, INC.



LOCATION OVERVIEW



The property is part of the Aerospace Technology Park in Brook Park, Ohio. The Park is located adjacent to NASA's Glenn Research Facility, near Cleveland Hopkins Airport, minutes from I-71, I-480, hotels, restaurants, and shopping areas.



The property offers flexible floor plans featuring private offices, conference and training rooms as well as open office space.



High tech construction insures a quiet environment.



T-8 lighting, white noise, 1" Thermal Pane windows with sound dampening glass



Advanced communication capabilities available to tenants.

FIRST + SECOND FLOOR PLANS

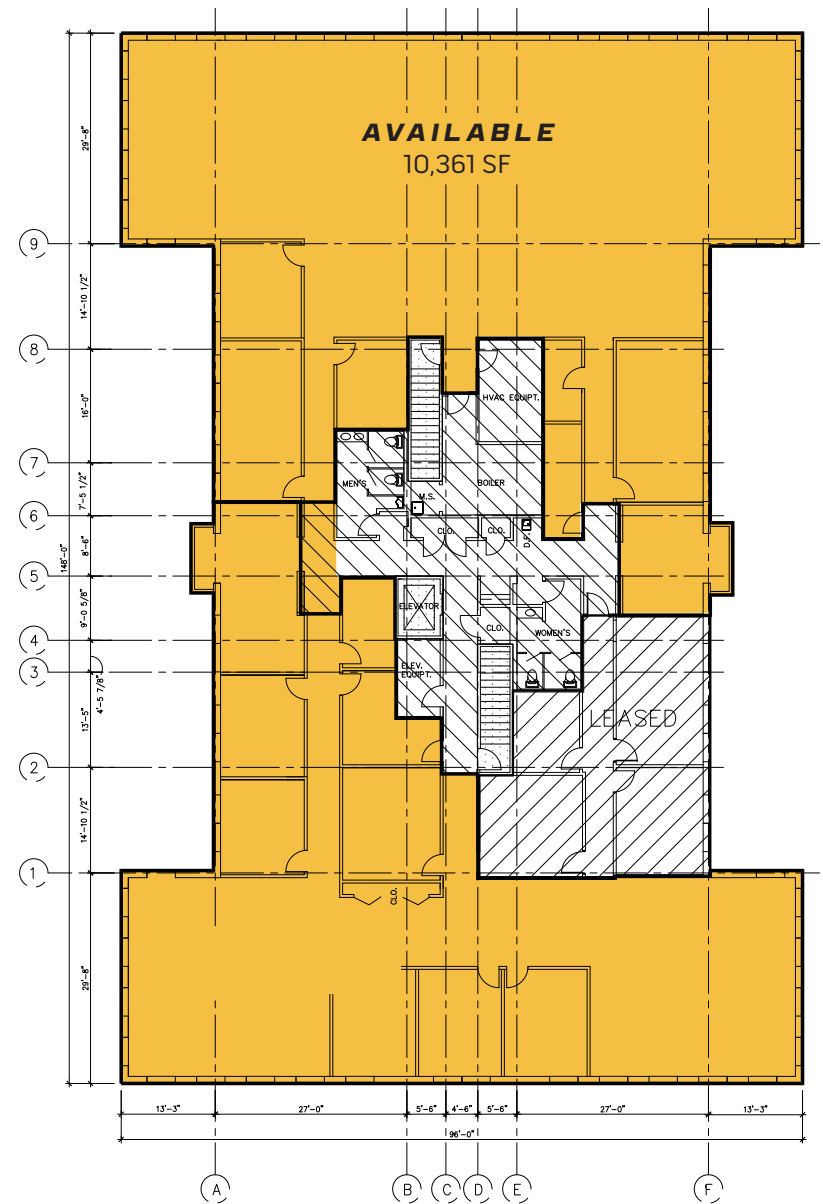
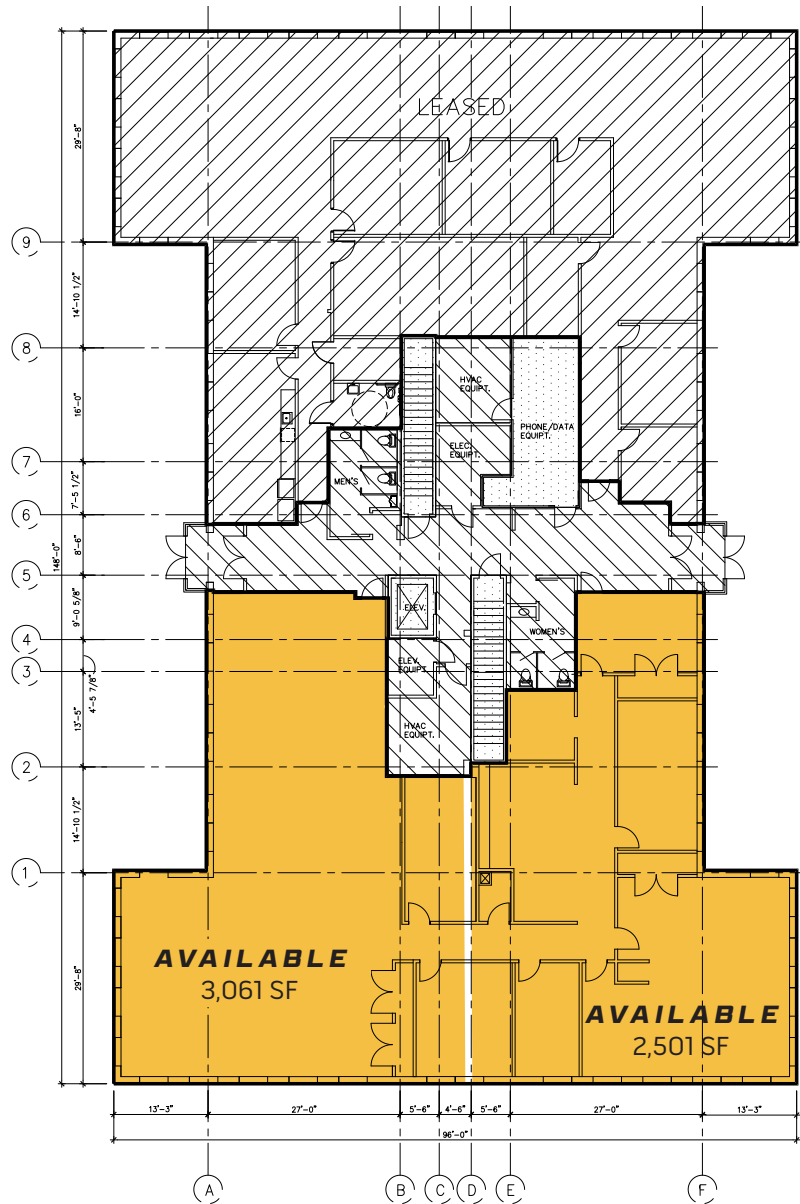

PARKING PLAN

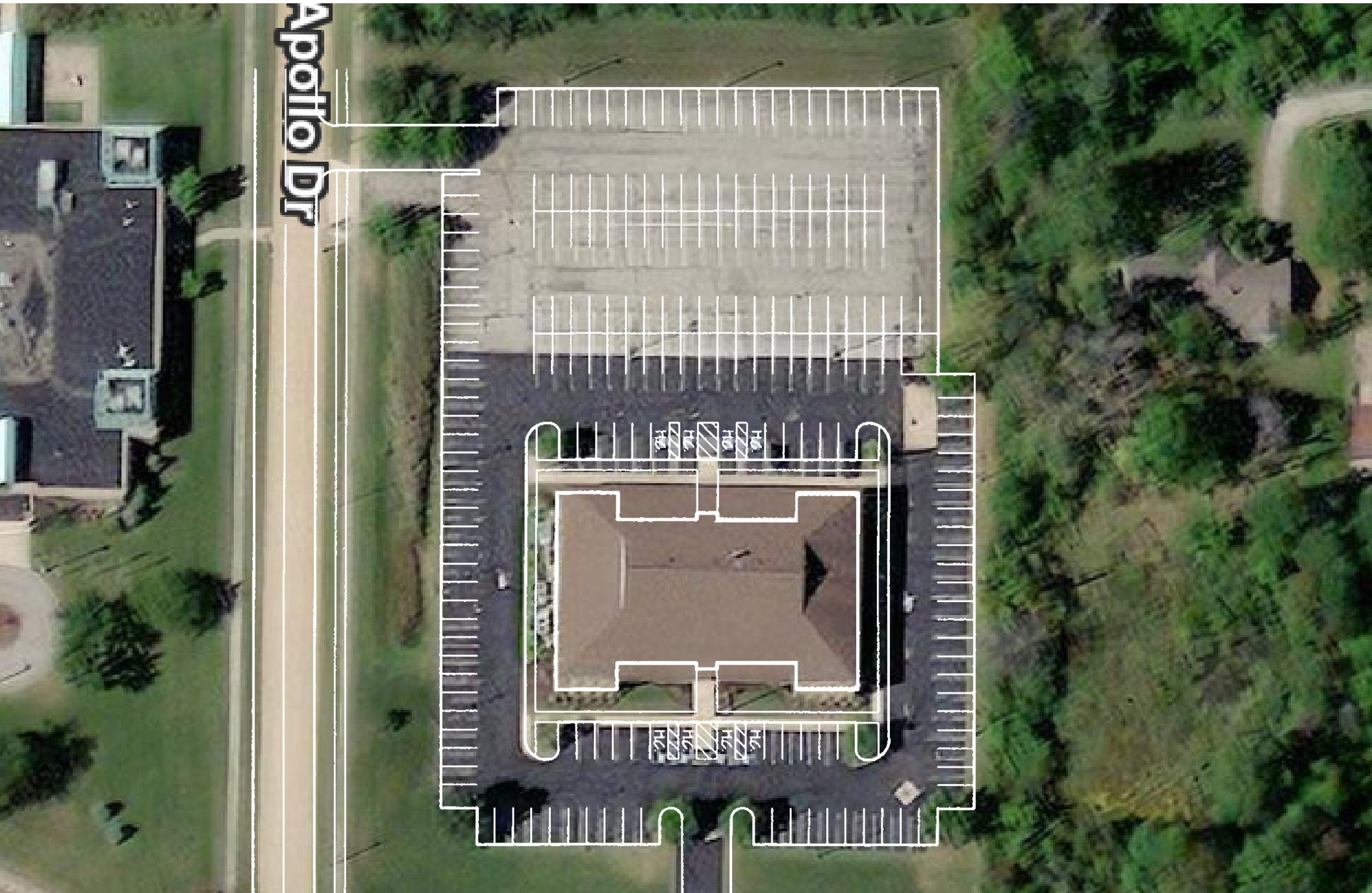

AREA MAP

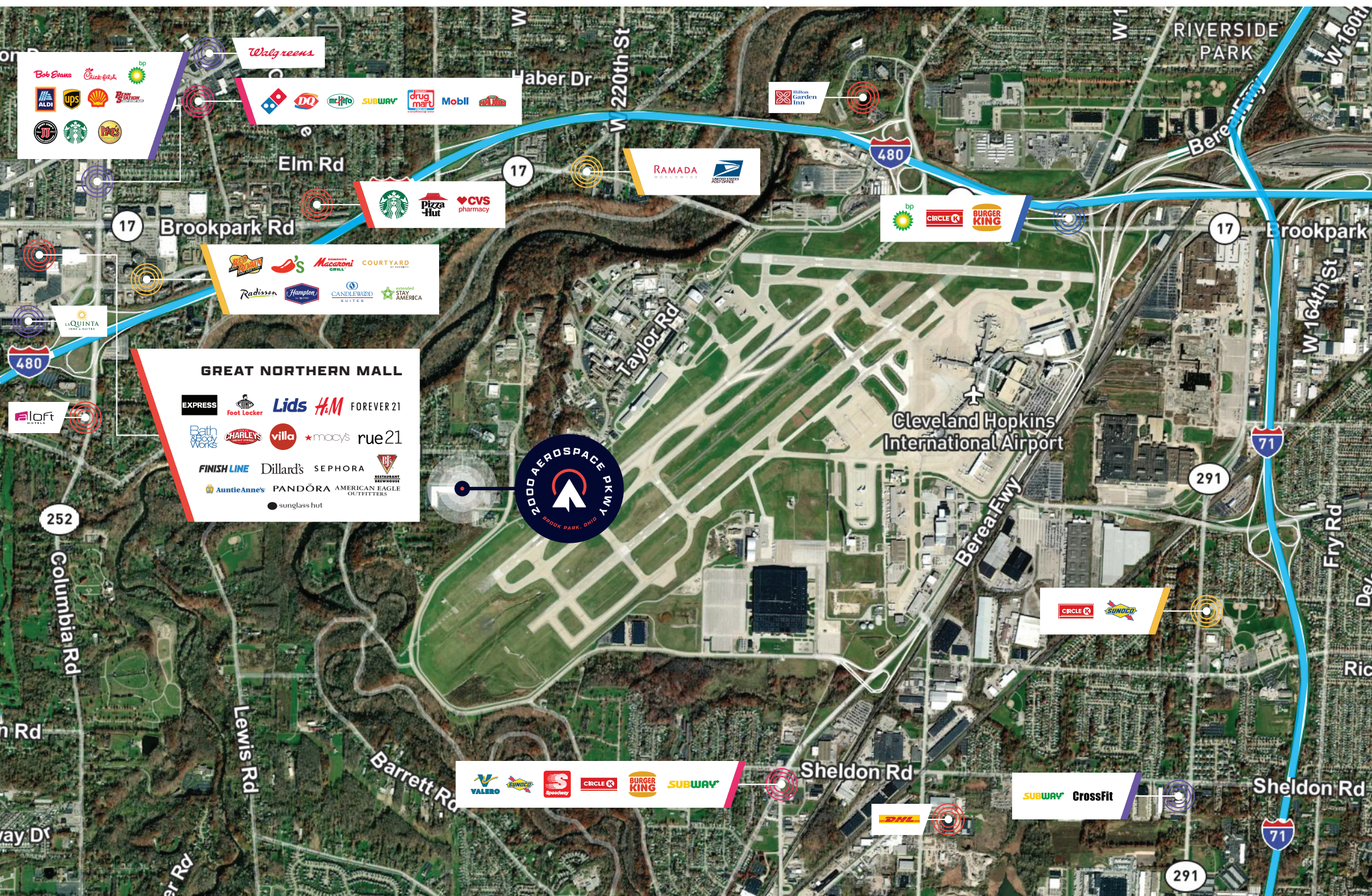



BOB LEIBOLD

Vice President

+1 216 363 6449

robert.leibold@cbre.com



©2022 CBRE, Inc. All rights reserved. This information has been obtained from sources believed reliable, but has not been verified for accuracy or completeness. You should conduct a careful, independent investigation of the property and verify all information. Any reliance on this information is solely at your own risk. CBRE and the CBRE logo are service marks of CBRE, Inc. All other marks displayed on this document are the property of their respective owners, and the use of such logos does not imply any affiliation with or endorsement of CBRE. Photos herein are the property of their respective owners. Use of these images without the express written consent of the owner is prohibited. PMStudio_June2022

CBRE